



CURTIS

Accessories



Windows PC Software Tool for Curtis Programmable Devices

Model 1314 - Version 4



Model 1314 - Version 4

Windows PC Software Tool for Curtis Programmable Devices



The 1314 Windows PC Software Tool provides comprehensive and intuitive PC based programming, monitoring and system diagnostics for all Curtis programmable motor speed controllers and control systems.

The 1314 Windows PC Software Tool is intended for use by vehicle OEMs, dealers, and service engineers. It provides a powerful Windows interface for adjusting settings, troubleshooting, and recording the parameters of any Curtis speed controller or auxiliary device.

FEATURES

- ▶ View and adjust controller programmable parameters.
- ▶ Real-time monitoring of system variables such as voltage, temperature, and current.
- ▶ Saves all data – parameter values, monitor values, history logs etc., in a single file.
- ▶ Edit, rename, export or print files online or offline.
- ▶ Clone data between controllers.
- ▶ View active fault codes and system timers.
- ▶ View and clear controller fault history log.
- ▶ Online help and automatic update function (with active internet connection).

SYSTEM REQUIREMENTS

The minimum requirements for the PC Hardware are:

- ▶ Processor Pentium III 833MHz
- ▶ Windows® XP/Vista/7
- ▶ 512MB memory (1024 recommended)
- ▶ USB port

MODEL CHART

Model Number	Part Number	Description	Comments
1314K-4401	17748700	OEM	Kit includes: CD-ROM, USB interface, Molex cable
1314K-3301	17748701	Dealer	Kit includes: CD-ROM, USB interface, Molex cable
1314K-2201	17748702	Service	Kit includes: CD-ROM, USB interface, Molex cable
1314K-1101	17748703	User	Kit includes: CD-ROM, USB interface, Molex cable

Cable Options	Part Number
Cable 4-Pin Molex	16185
Cable XLR	36378005

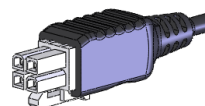
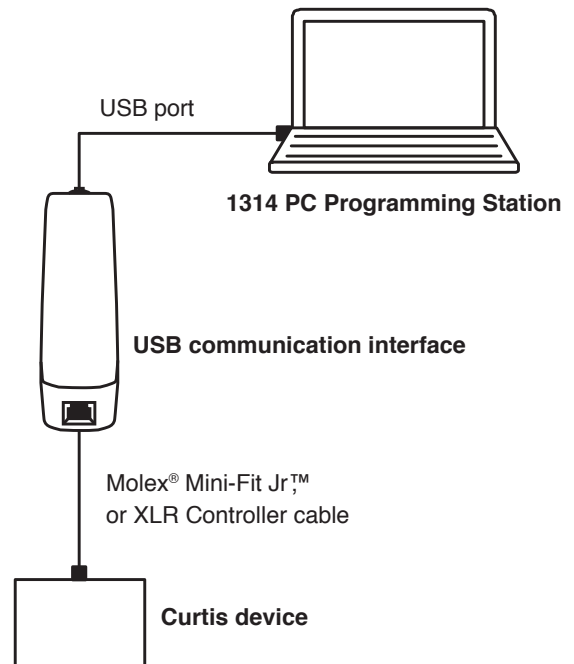

4-Pin Molex

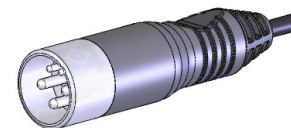

XLR

Model 1314 - Version 4

Windows PC Software Tool for Curtis Programmable Devices



TYPICAL PROGRAMMING SCREENS

Parameter Editor

Name	Value	Unit
Program		
Multimode Functions		
M1 Forward Max Speed	1	rpm
M2 Forward Max Speed	1	rpm
M1 Reverse Max Speed	1	rpm
M2 Reverse Max Speed	1	rpm
Hydraulic Functions		
Lift Lockout Enable	On	
Lift Lockout BDI	20	%
Hydraulic Inhibit	On	
Lower Valve PWM	100	%
HourMeter Preset		
10s of Hours	0	
Remaining HRs in Mins	0	
Preset Total Hourmeter	Off	
Preset Traction Hourmeter	Off	
Preset Pump Hourmeter	Off	
Battery		
Reset Volts Per Cell	2.090	Volt
Full Volts Per Cell	2.040	Volt
Empty Volts Per Cell	1.730	Volt
Discharge Time	34	Minutes
BDI Reset Percent	75	%

CAN USB **S** Access Level: Dealer Ready.

Settings - Communication

Select interface:

Select mode: CAN Serial

Virtual Serial Port: COM3

OK Cancel

System Information (Online)

Model: 1234_6_8_Sem
 Serial Number: 17775
 Protocol Version: 2
 Parameter Block Version: 0
 Model Number: 12345276
 Mfg Date Code: 8086
 Hardware Version: 0.000
 OS Version: 12
 Build Number: 0
 SW Version: 2.00
 Param BK Version: 1.03
 VCI App Version: 0.00

Additional Information

System data (Shipping info) Notes

System Type:

Sen -Main, right motor:

Sen -Main, left motor:

Access Level: OEM Ready.

Monitor (Online)

Name	Value	Unit	Watch	Value	Unit
Inputs Throttle Command	0.0	%	<input checked="" type="checkbox"/>	0.0	%
Inputs Mapped Throttle	0.0	%	<input checked="" type="checkbox"/>	0.0	%
Inputs Throttle Pot	0.21	Volt	<input checked="" type="checkbox"/>	0.21	Volt
Inputs Brake Command	0.0	%	<input checked="" type="checkbox"/>	0.0	%
Inputs Mapped Brake	0.0	%	<input checked="" type="checkbox"/>	0.0	%
Pot2 Raw	0.21	Volt	<input checked="" type="checkbox"/>	0.21	Volt
PD Throttle	0.00	%	<input checked="" type="checkbox"/>	0.00	%
Stare Pot	0.00	Volt	<input checked="" type="checkbox"/>	0.00	Volt
Steer Angle (deg)	0		<input checked="" type="checkbox"/>	0	
Interlock	OFF		<input checked="" type="checkbox"/>	OFF	
Error Flw	OFF		<input checked="" type="checkbox"/>	OFF	
Analog 1	0.00	Volt	<input checked="" type="checkbox"/>	0.00	Volt
Analog 2	1.32	Volt	<input checked="" type="checkbox"/>	1.32	Volt
Switch 1	OFF		<input checked="" type="checkbox"/>	OFF	
Switch 2	OFF		<input checked="" type="checkbox"/>	OFF	
Switch 3	OFF		<input checked="" type="checkbox"/>	OFF	
Switch 4	OFF		<input checked="" type="checkbox"/>	OFF	
Switch 5	OFF		<input checked="" type="checkbox"/>	OFF	
Switch 6	OFF		<input checked="" type="checkbox"/>	OFF	
Switch 7	ON		<input checked="" type="checkbox"/>	ON	
Switch 8	OFF		<input checked="" type="checkbox"/>	OFF	
Driver 1 Input	ON		<input checked="" type="checkbox"/>	ON	
Driver 2 Input	ON		<input checked="" type="checkbox"/>	ON	
Driver 3 Input	OFF		<input checked="" type="checkbox"/>	OFF	
Driver 4 Input	OFF		<input checked="" type="checkbox"/>	OFF	
PD Input	OFF		<input checked="" type="checkbox"/>	OFF	
DiagOut1 Input	OFF		<input checked="" type="checkbox"/>	OFF	
DiagOut2 Input	OFF		<input checked="" type="checkbox"/>	OFF	

Logging Interval time: 500 Start Stop

Access Level: OEM Ready.

WARRANTY Two year limited warranty from time of delivery.

The Curtis Difference 
 You feel it when you drive it