



# RR5200

IT EN DE FR ES PT

RR5200 L.. .. **i**



i	T <sub>2</sub> [Nm]						n <sub>1max</sub> [min <sup>-1</sup> ]	T <sub>2max</sub> [Nm]	P <sub>t</sub> [kW]	
	n <sub>2</sub> x h									
1/...	10000 (10 <sup>4</sup> )	25000 (2.5 · 10 <sup>4</sup> )	50000 (5 · 10 <sup>4</sup> )	100000 (10 <sup>5</sup> )	500000 (5 · 10 <sup>5</sup> )	1000000 (10 <sup>6</sup> )				
<b>RR5200 L1</b>	<b>4.17</b>	62150	57390	55540	51490	35510	28840	1000	92000	59
	<b>4.84</b>	55910	49540	43610	41380	34810	28270	1000	92000	59
	<b>5.87</b>	44070	37200	33370	31980	28970	27690	1000	92000	59
<b>RR5200 L2</b>	<b>16.28</b>	62150	57390	55540	51490	35510	28840	2000	92000	35
	<b>18.41</b>	62150	54150	51900	49740	35510	28840	2000	92000	35
	<b>21.36</b>	55910	49540	43610	41380	34810	28270	2000	92000	35
	<b>24.90</b>	55420	49540	43610	41380	34810	28270	2000	92000	35
	<b>30.37</b>	41060	38360	36760	35230	31920	28270	2000	92000	35
	<b>36.80</b>	44070	37200	33370	31980	28970	27690	2000	92000	35
<b>RR5200 L3</b>	<b>55.35</b>	62150	57390	55540	47170	29100	23640	3500	92000	25
	<b>65.11</b>	62150	57390	55540	45720	28210	22920	3500	92000	25
	<b>73.66</b>	62150	54150	51900	49740	30760	24980	3500	92000	25
	<b>92.07</b>	51610	48790	46760	44820	30380	24680	3500	92000	25
	<b>106.81</b>	55910	49540	43610	41380	33710	27380	3500	92000	25
	<b>124.51</b>	55420	49540	43610	41380	34810	28270	3500	92000	25
	<b>144.43</b>	55420	49540	43610	41380	34810	28270	3500	92000	25
	<b>174.32</b>	43140	40790	39090	37470	34580	28270	3500	92000	25
	<b>212.61</b>	41060	38360	36760	35230	31920	28270	3500	92000	25
	<b>257.60</b>	44070	37200	33370	31980	28970	27690	3500	92000	25
<b>RR5200 L4</b>	<b>188.18</b>	62150	57390	55540	47170	29100	23640	3500	92000	20
	<b>221.38</b>	62150	57390	55540	47170	29100	23640	3500	92000	20
	<b>276.73</b>	62150	57390	55540	47170	29100	23640	3500	92000	20
	<b>325.57</b>	62150	57390	55540	45720	28210	22920	3500	92000	20
	<b>377.66</b>	62150	57390	55540	45720	28210	22920	3500	92000	20
	<b>427.21</b>	62150	54150	51900	49740	30760	24980	3500	92000	20
	<b>515.60</b>	62150	54150	51900	49740	30760	24980	3500	92000	20
	<b>644.50</b>	51610	48790	46760	44820	30380	24680	3500	92000	20
	<b>718.63</b>	52450	49540	43610	41380	33060	26860	3500	92000	20
	<b>871.58</b>	55420	49540	43610	41380	34810	28270	3500	92000	20
	<b>1011.03</b>	55420	49540	43610	41380	34810	28270	3500	92000	20
	<b>1220.21</b>	43140	40790	39090	37470	34580	28270	3500	92000	20
	<b>1488.29</b>	41060	38360	36760	35230	31920	28270	3500	92000	20
	<b>1803.20</b>	44070	37200	33370	31980	28970	27690	3500	92000	20

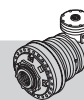

RR5200

A..

..

i



	i	T <sub>2</sub> [Nm]						n <sub>1max</sub> [min <sup>-1</sup> ]	T <sub>2max</sub> [Nm]	P <sub>t</sub> [kW]
		n <sub>2</sub> x h								
		10000 (10 <sup>4</sup> )	25000 (2.5 · 10 <sup>4</sup> )	50000 (5 · 10 <sup>4</sup> )	100000 (10 <sup>5</sup> )	500000 (5 · 10 <sup>5</sup> )	1000000 (10 <sup>6</sup> )			
<b>RR5200 A2 (A)</b>	<b>11.38</b>	25480	25480	21110	17150	10580	8590	2500	60720	41
	<b>13.21</b>	29560	28840	23420	19030	11740	9540	2500	70470	41
	<b>16.00</b>	35820	32980	26790	21760	13430	10910	2500	85400	41
	<b>19.36</b>	31160	31160	25790	20950	12930	10500	2500	85380	41
	<b>22.81</b>	28060	28060	24350	19780	12200	9910	2500	85370	41
	<b>(B)</b>									
	<b>11.56</b>	29110	28300	25070	20360	12560	10210	2500	72880	46
	<b>13.41</b>	33000	32840	27810	22590	13940	11320	2500	84550	46
	<b>16.25</b>	39780	37200	31810	25840	15940	12950	2500	92000	46
	<b>18.58</b>	35820	35820	32210	26170	16150	13110	2500	92000	46
	<b>24.00</b>	27470	27470	27470	26010	16050	13040	2500	92000	46
	<b>(C)</b>									
	<b>10.27</b>	62150	57390	53100	43130	26620	21620	2000	81010	58
	<b>11.92</b>	55910	49540	43610	41380	29530	23990	2000	92000	58
	<b>13.22</b>	51440	51440	51440	43100	26590	21600	2000	80980	58
	<b>15.33</b>	55910	49540	43610	41380	29500	23970	2000	92000	58
	<b>18.49</b>	50740	49540	43610	41380	29120	23660	2000	92000	58
	<b>22.40</b>	44070	37200	33370	31980	28970	27060	2000	92000	58
<b>RR5200 A3 (A)</b>	<b>43.83</b>	33920	26900	21850	17750	10950	8900	3500	92000	28
	<b>49.58</b>	38370	29330	23820	19350	11940	9700	3500	92000	28
	<b>57.51</b>	42840	32540	26430	21470	13250	10760	3500	92000	28
	<b>67.04</b>	47690	36230	29430	23900	14750	11980	3500	92000	28
	<b>81.77</b>	41060	38360	33820	27470	16950	13770	3500	92000	28
	<b>99.08</b>	44070	37200	33370	31420	19380	15750	3500	92000	28
	<b>116.06</b>	44070	37200	33370	30940	19090	15510	3500	92000	28
	<b>147.20</b>	43250	37200	33370	29640	18290	14860	3500	92000	28
	<b>(B)</b>									
	<b>44.40</b>	62150	57390	53360	43350	26750	21720	2500	92000	33
	<b>50.22</b>	62150	54150	51900	47250	29160	23680	2500	92000	33
	<b>58.26</b>	55910	49540	43610	41380	32350	26280	2500	92000	33
	<b>67.92</b>	55420	49540	43610	41380	34810	28270	2500	92000	33
	<b>70.50</b>	55910	49540	43610	41380	31150	25300	2500	92000	33
	<b>83.08</b>	55910	49540	43610	41380	29400	23880	2500	92000	33
	<b>96.84</b>	55420	49540	43610	41380	32730	26580	2500	92000	33
	<b>118.12</b>	41060	38360	36760	35230	31920	28270	2500	92000	33
	<b>143.11</b>	44070	37200	33370	31980	28970	27690	2500	92000	33
	<b>(C)</b>									
	<b>45.08</b>	62150	57390	55540	51470	31760	25800	2500	92000	34
	<b>50.99</b>	62150	54150	51900	49740	34620	28120	2500	92000	34
	<b>58.31</b>	62150	54150	51900	49740	35060	28480	2500	92000	34
	<b>66.59</b>	62150	57390	55540	51490	31970	25960	2500	92000	34
	<b>75.33</b>	62150	54150	51900	49740	34850	28300	2500	92000	34
	<b>87.39</b>	55910	49540	43610	41380	34810	28270	2500	92000	34
	<b>101.87</b>	55420	49540	43610	41380	34810	28270	2500	92000	34
	<b>124.25</b>	41060	38360	36760	35230	31920	28270	2500	92000	34
	<b>150.55</b>	44070	37200	33370	31980	28970	27690	2500	92000	34
<b>RR5200 A4</b>	<b>149.01</b>	62150	57390	50180	40760	25150	20430	3500	92000	23
	<b>175.30</b>	62150	57390	55540	45670	28180	22890	3500	92000	23
	<b>198.31</b>	62150	54150	51900	49740	30720	24950	3500	92000	23
	<b>247.89</b>	51610	48790	46760	44820	30380	24680	3500	92000	23
	<b>290.38</b>	51610	48790	46760	44820	30380	24680	3500	92000	23
	<b>368.29</b>	51610	48790	46760	44820	30380	24680	3500	92000	23
	<b>427.24</b>	55910	49540	43610	41380	33710	27380	3500	92000	23
	<b>498.05</b>	55420	49540	43610	41380	34810	28270	3500	92000	23
	<b>577.73</b>	55420	49540	43610	41380	34810	28270	3500	92000	23
	<b>697.26</b>	43140	40790	39090	37470	34580	28270	3500	92000	23
	<b>850.45</b>	41060	38360	36760	35230	31920	28270	3500	92000	23
	<b>1030.40</b>	44070	37200	33370	31980	28970	27690	3500	92000	23



# RR5200

IT EN DE FR ES PT

RR5200 L.. .. i



L1

MS MC FS MH 235 RR5200 L1

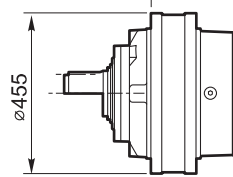

L2

MS MC FS MH 350 RR5200 L2

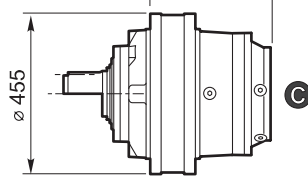

ZI 364 RR5200 L2

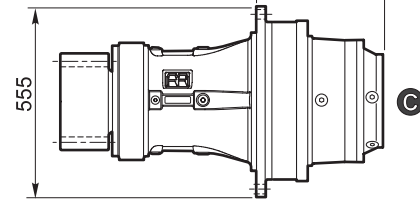

L3

MS MC FS MH 426 RR5200 L3

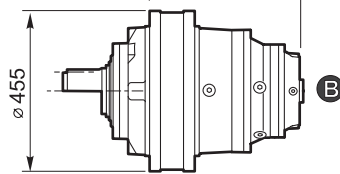

ZI 440 RR5200 L3

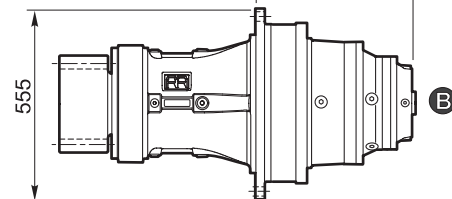

L4

MS MC FS MH 492.5 RR5200 L4

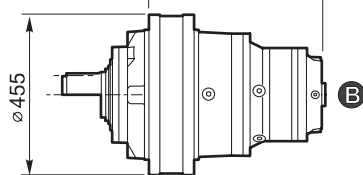

ZI 506.5 RR5200 L4

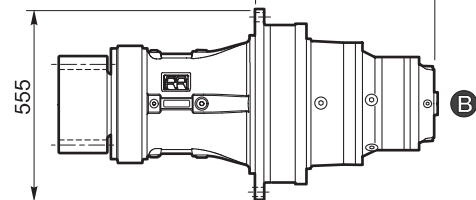

**CFG**

RF BOC	
B C D	

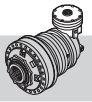

RR5200 A.. .. i

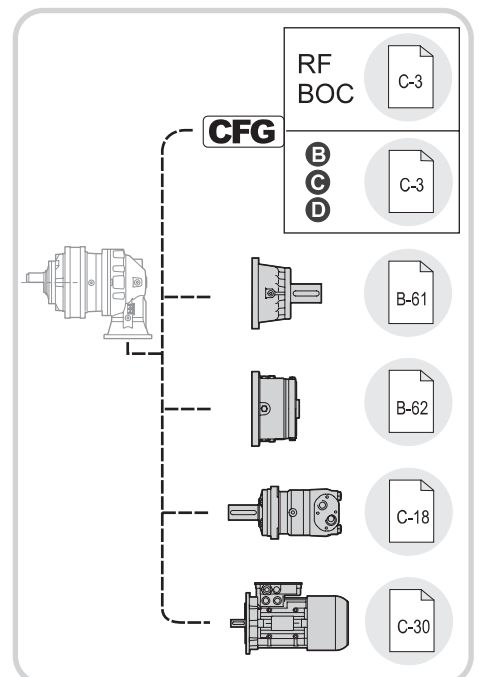
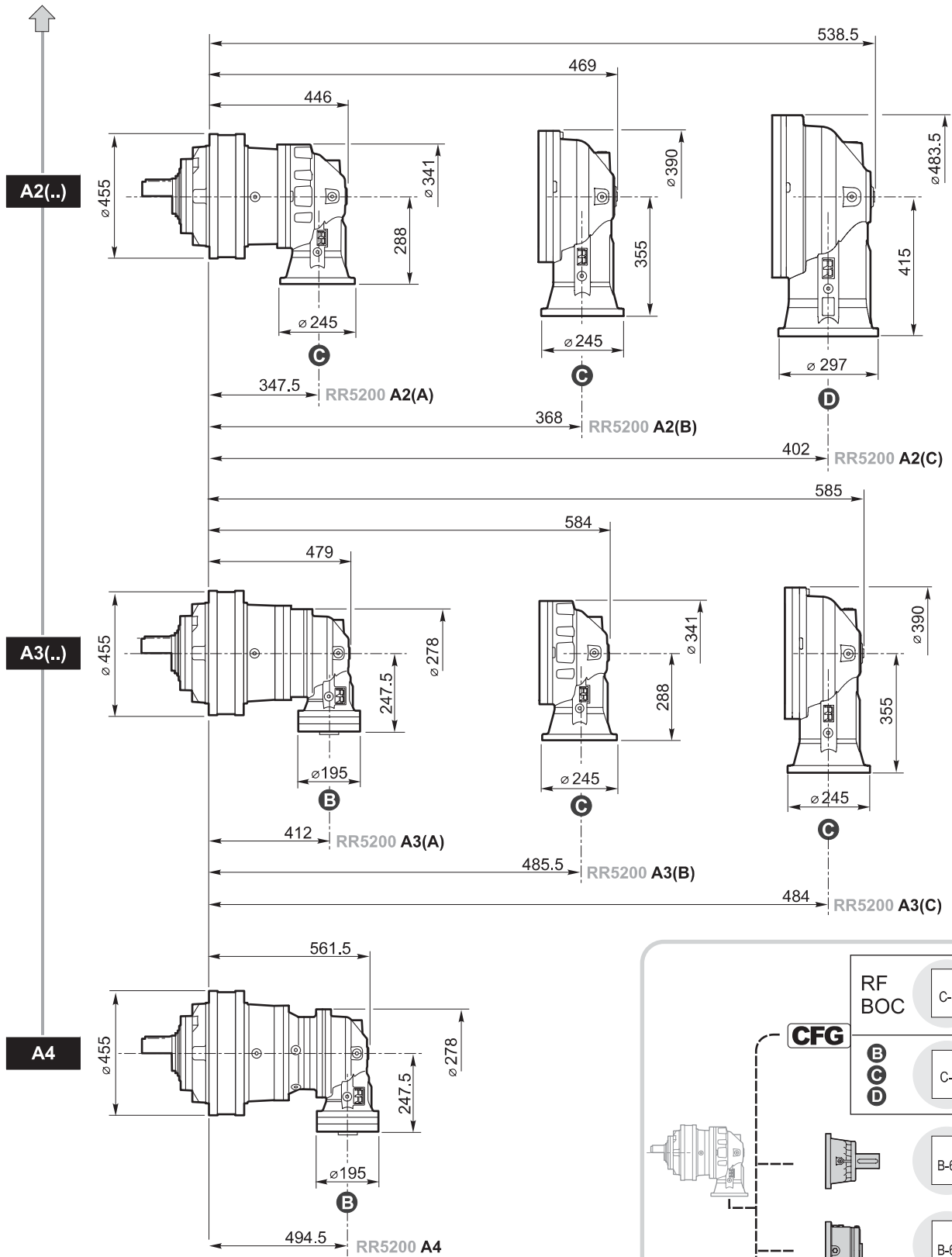

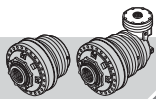

# RR5200

IT EN DE FR ES PT

RR5200	L..	<b>MS</b>	i
RR5200	A..		i

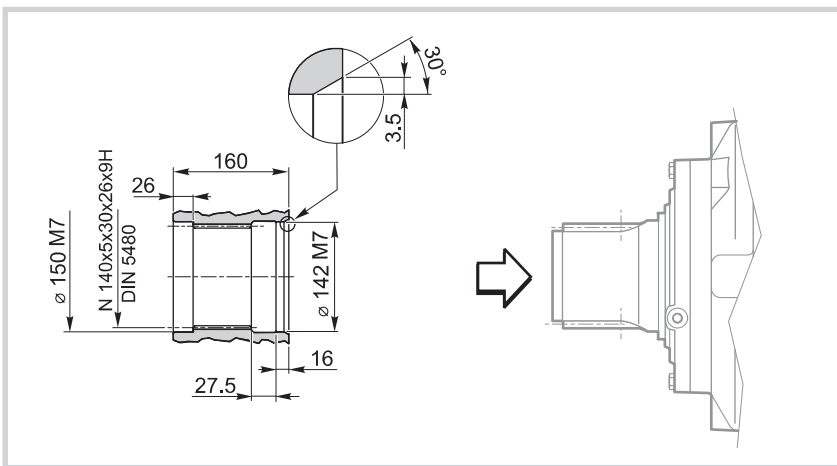
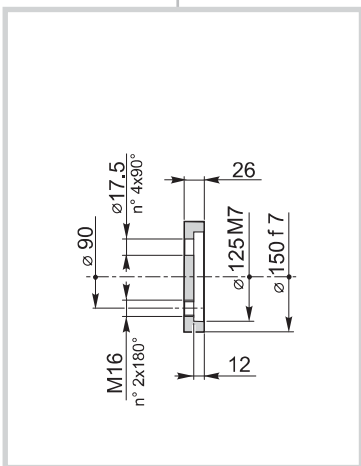
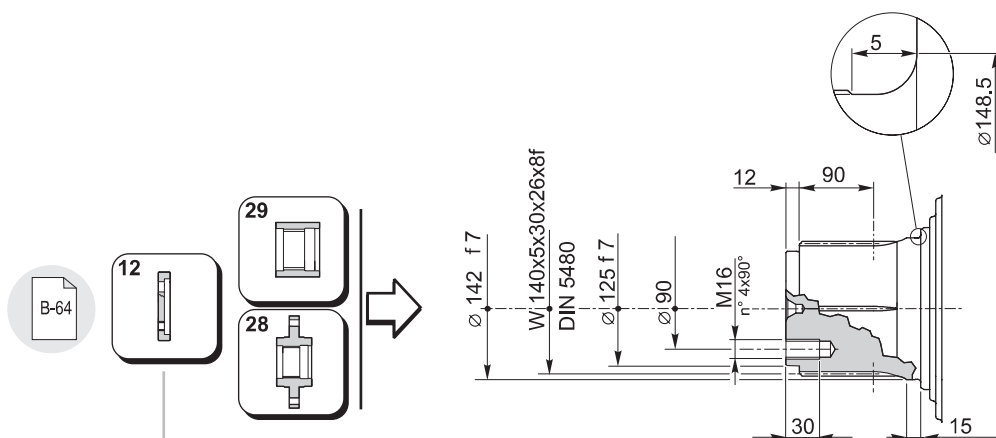
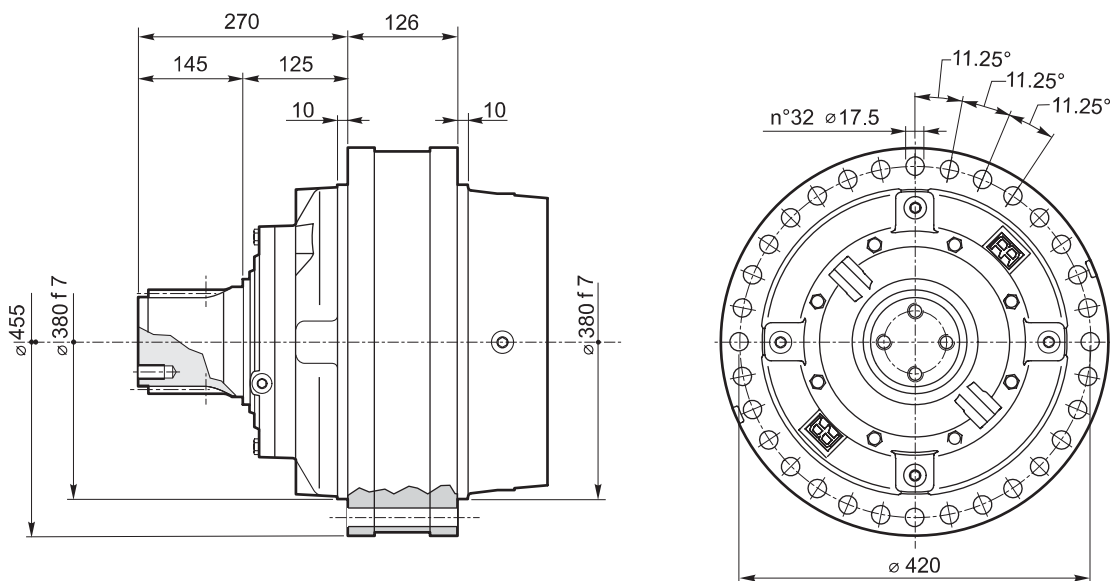

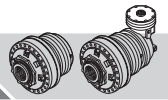

RR5200	L..	<b>MC</b>	i
RR5200	A..		i

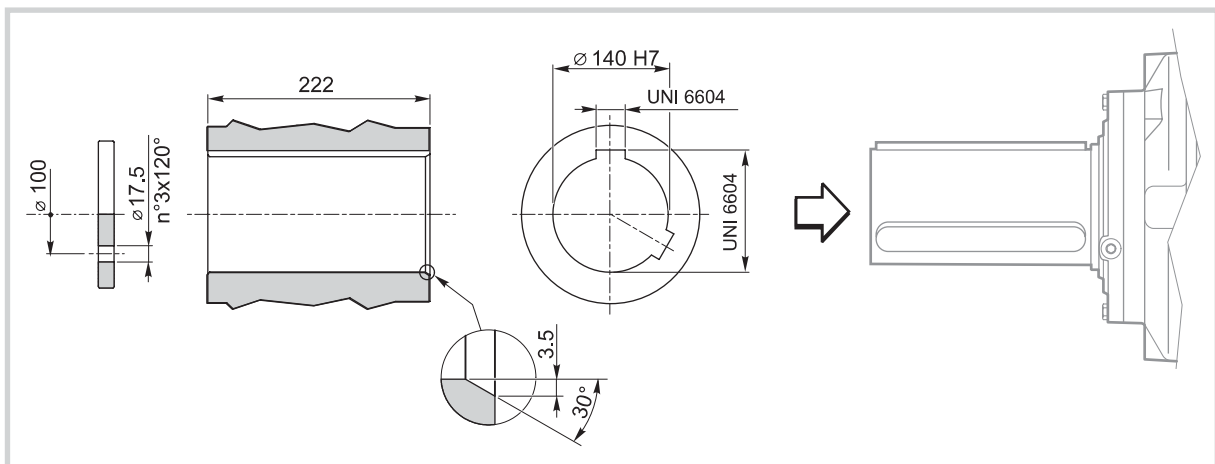
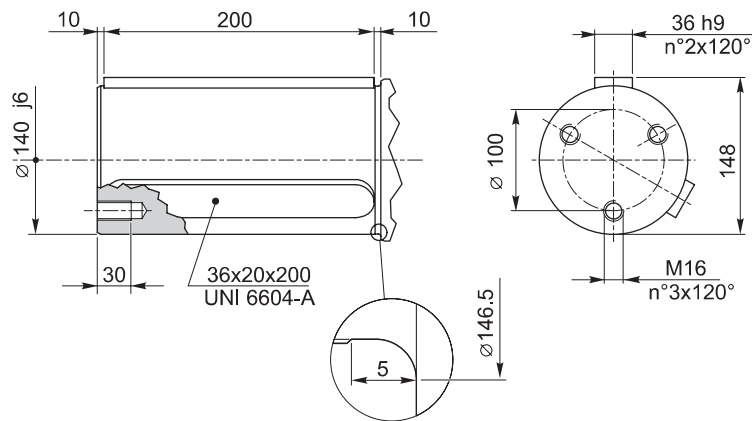
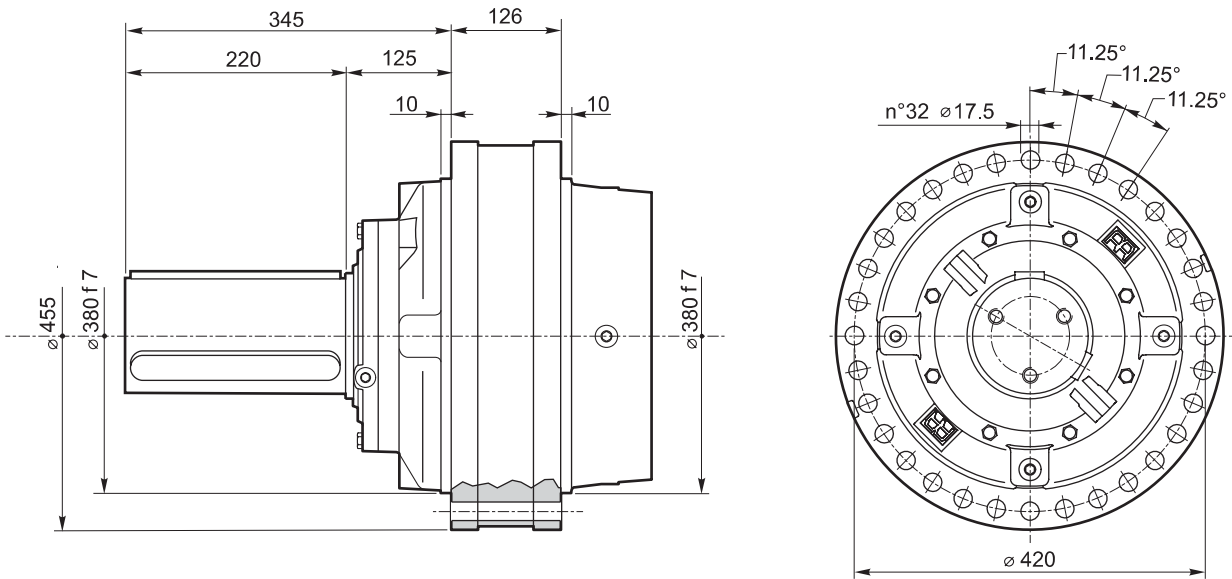

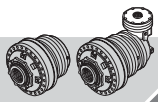

# RR5200

IT EN DE FR ES PT

RR5200	L..	<b>FS</b>	i
RR5200	A..		i

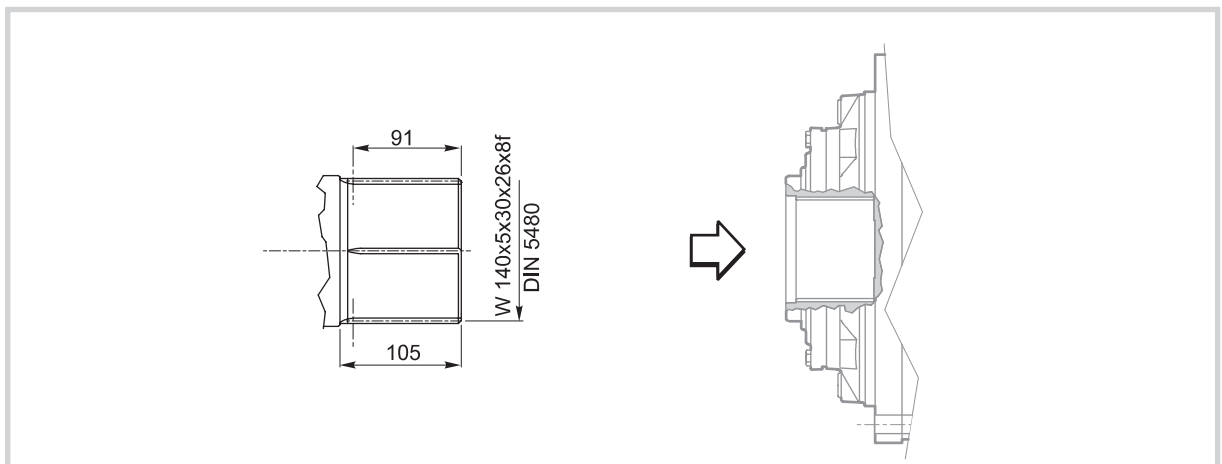
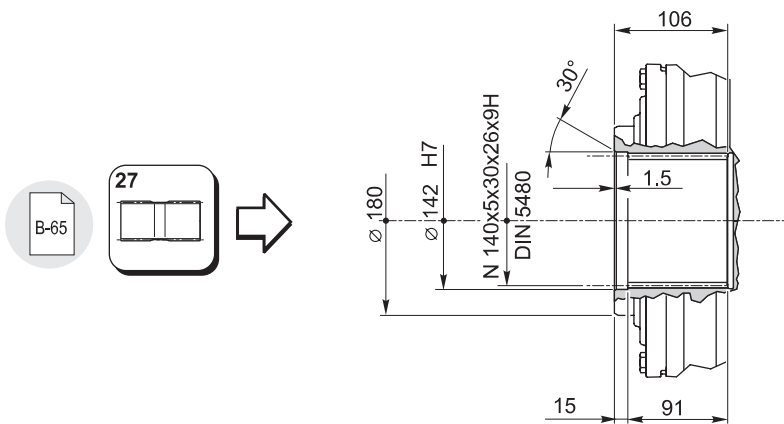
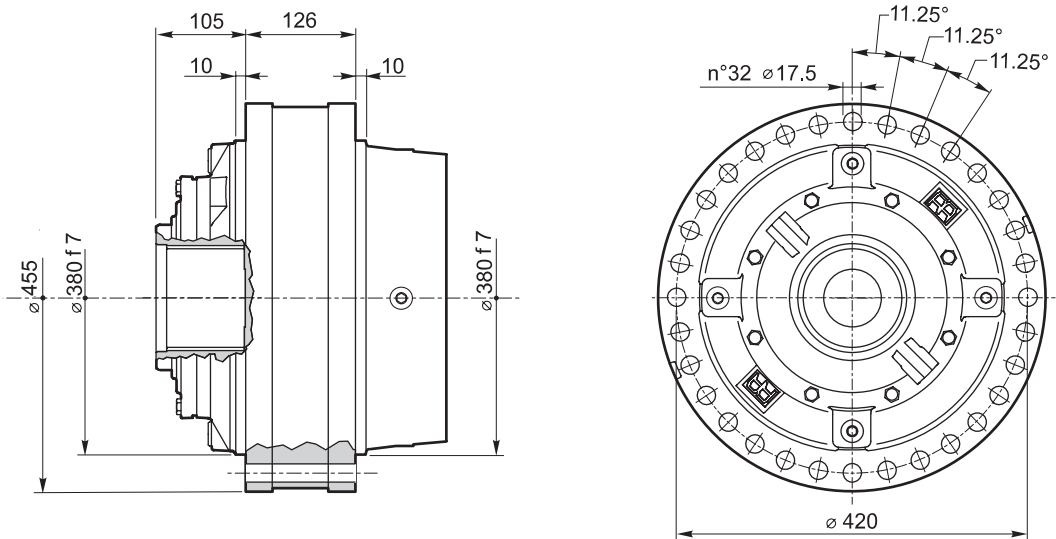

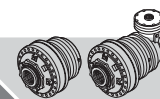

RR5200	L..	<b>MH</b>	i
RR5200	A..		i

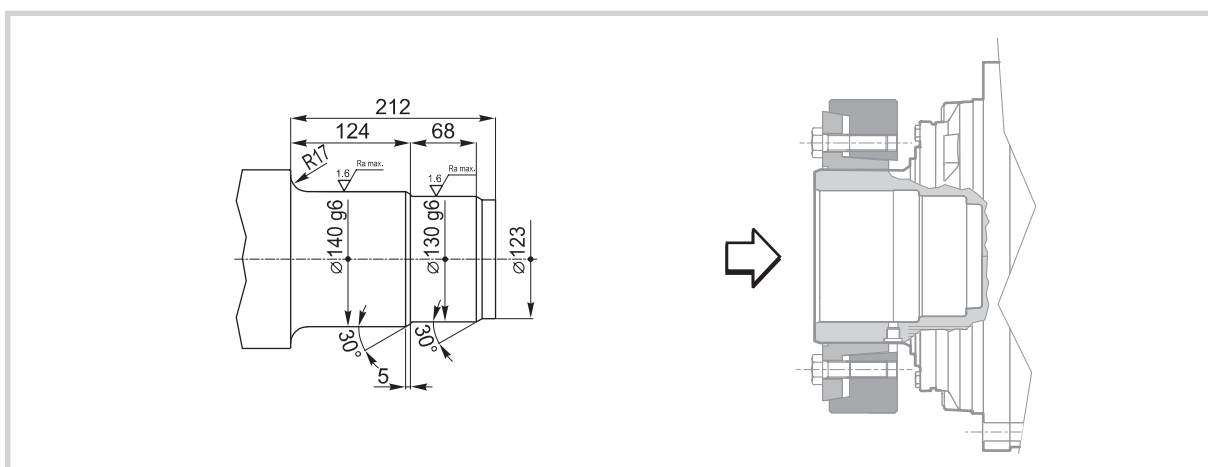
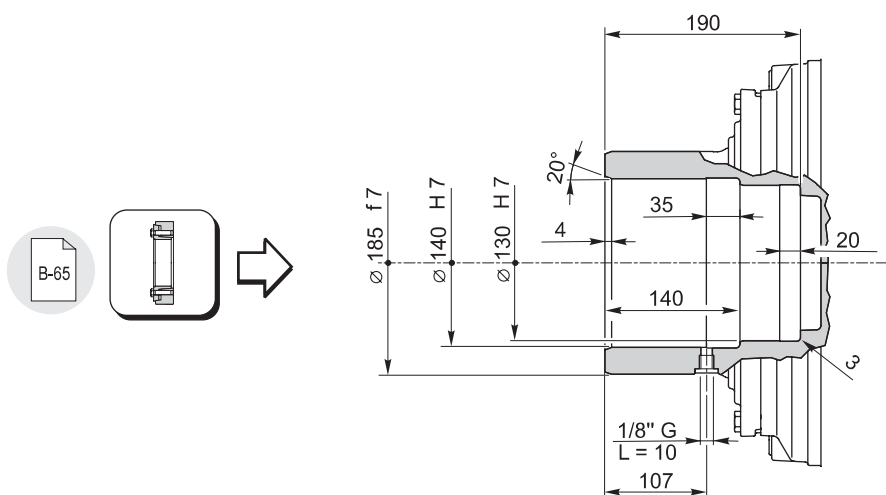
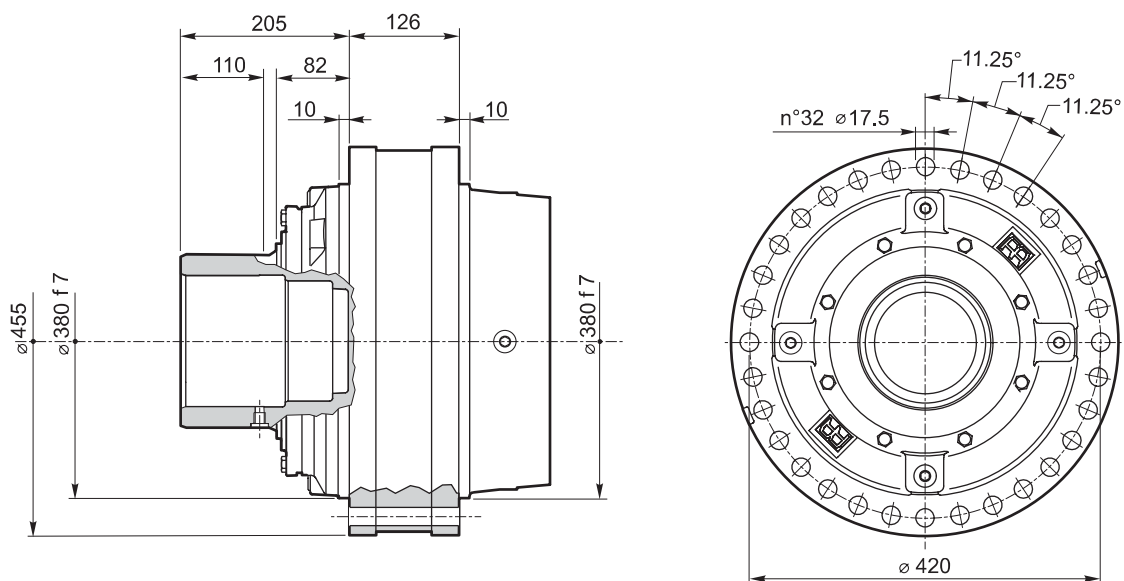





# RR5200

IT EN DE FR ES PT

RR5200 L.. ZI i

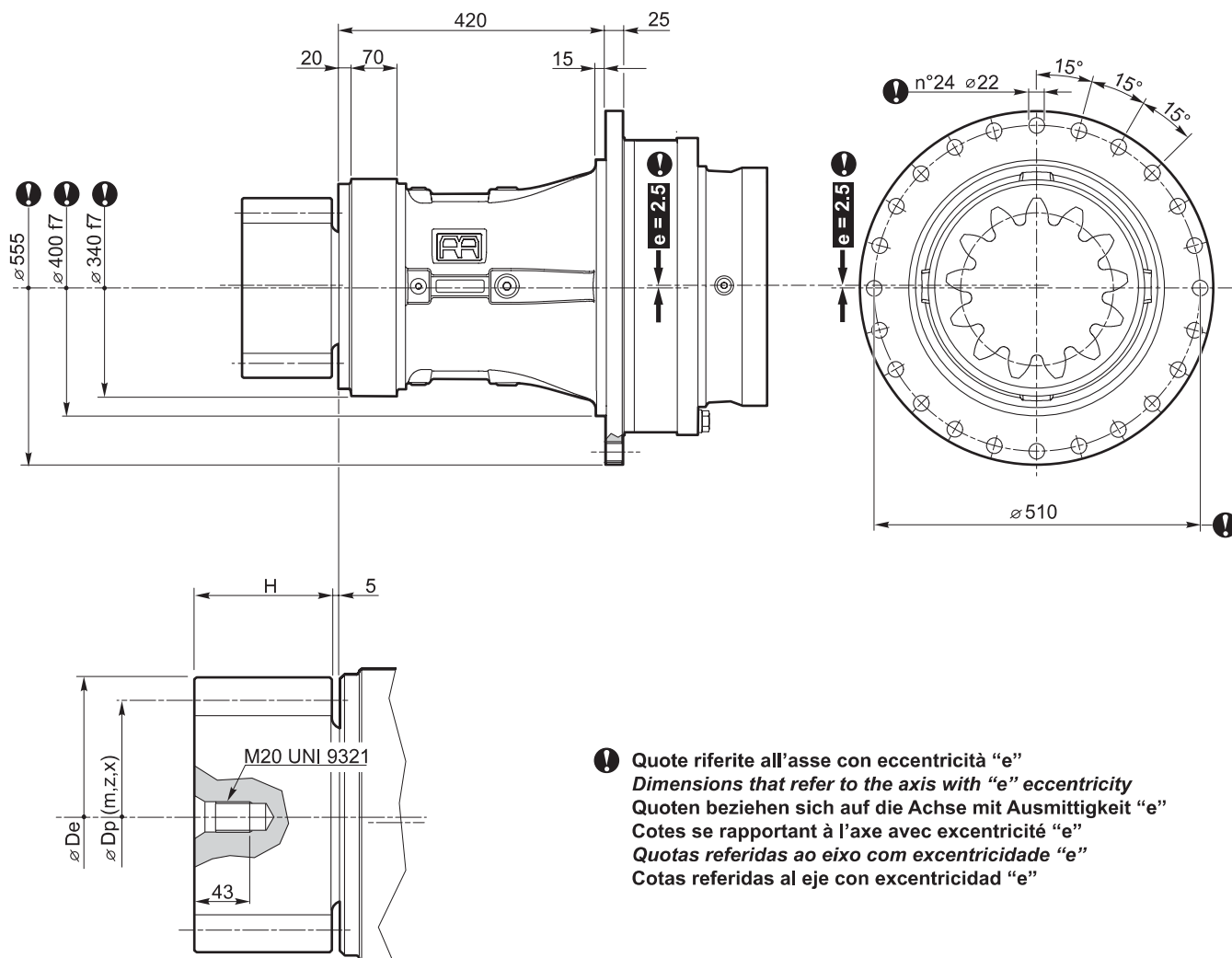

! Quote riferite all'asse con eccentricità "e"  
 Dimensions that refer to the axis with "e" eccentricity  
 Quoten beziehen sich auf die Achse mit Ausmittigkeit "e"  
 Cotes se rapportant à l'axe avec excentricité "e"  
 Quotas referidas ao eixo com excentricidade "e"  
 Cotas referidas al eje con excentricidad "e"

	m	z	x	H	Dp	De	code
	16	14	0.5	150	224	272	03-644
	18	14	0.5	150	252	306	03-643
	20	12	0.5	150	240	300	03-645

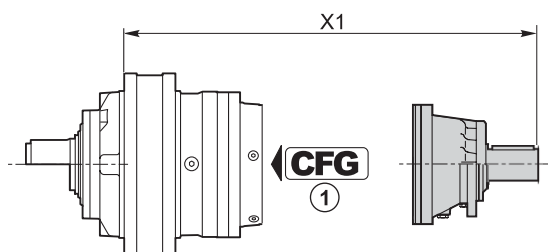
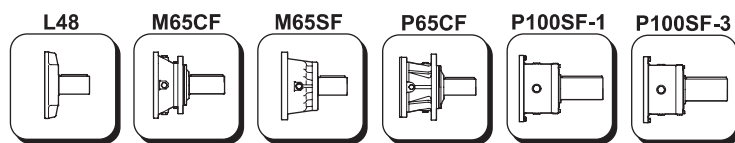

	CFG ①		code	X1
RR5200 L1	—	P100SF-3	154F3324	612
RR5200 L2	—	P65CF	154-2404	662
RR5200 L3	RF	M65SF	154B4249	610.5
	RF	M65CF	154-2407	633.5
	BOC	L48	154B3989	547.3
RR5200 L4	RF	M65SF	154B4249	677
	RF	M65CF	154-2407	700
	BOC	L48	154B3989	613.8

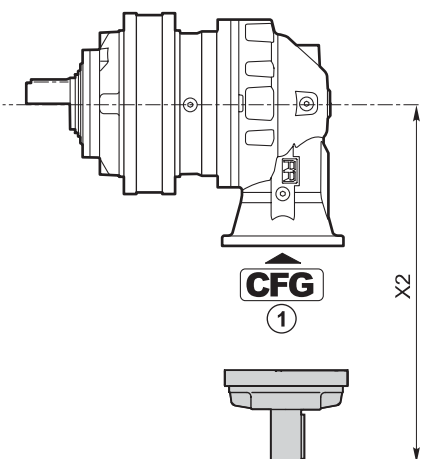

	CFG ①		code	X2
RR5200 A2(A)	—	P65CF	154-2404	600
RR5200 A2(B)	—	P65CF	154-2404	667
RR5200 A2(C)	—	P100SF-1	154F3322	791.5
RR5200 A3(A)	BOC	L48	154B3989	347.8
RR5200 A3(B)	—	P65CF	154-2404	600
RR5200 A3(C)	—	P65CF	154-2404	667
RR5200 A4	BOC	L48	154B3989	347.8

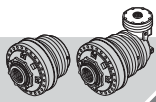

# RR5200

IT EN DE FR ES PT

RF170-290



RF5/..

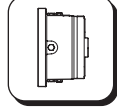

RFF5/..

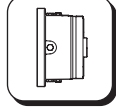

RF2/..

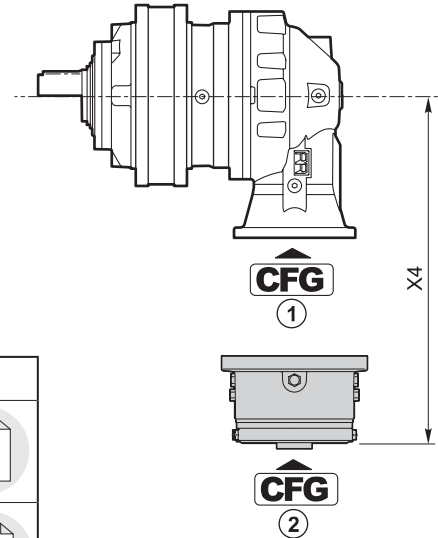
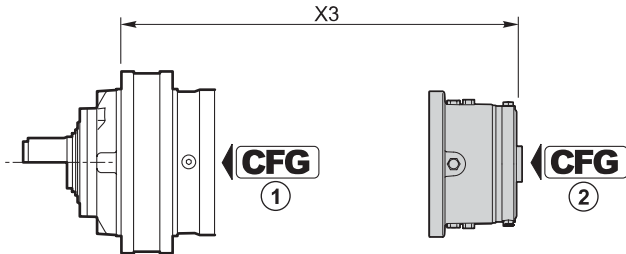
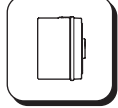

RF170-290	CFG ①	T <sub>f</sub> [Nm]	CFG ②		
			C		
			code	X3	X4
RR5200 L2	RF	1700	154B9766M2	547	—
		2000	154B9767M2		
		2300	154B9768M2		
		2900	154B9769M2		
RR5200 A2(A)	—	1700	154B9766M3	—	485
		2000	154B9767M3		
		2300	154B9768M3		
		2900	154B9769M3		
RR5200 A2(B)	—	1700	154B9766M3	—	552
		2000	154B9767M3		
		2300	154B9768M3		
		2900	154B9769M3		
RR5200 A3(B)	—	1700	154B9766M3	—	485
		2000	154B9767M3		
		2300	154B9768M3		
		2900	154B9769M3		
RR5200 A3(C)	—	1700	154B9766M3	—	552
		2000	154B9767M3		
		2300	154B9768M3		
		2900	154B9769M3		

CFG	
RF BOC	C-3
B C D	C-3

RF5/..	CFG ①	T <sub>f</sub> [Nm]	CFG ②						
			B			OMTS 12/24 z16	OMVS 10/20 z16		
			code	X3	X4	code	code	X3	X4
RR5200 L3	RF	210	154-2872	516.3	—	154-2879	154-2886	520	—
		290	154-2873			154-2880	154-2887		
		430	154-2874			154-2881	154-2888		
		650	154-2875			154-2882	154-2889		
		850	154-2876			154-2883	154-2890		
		1100	154-2877			154-2884	154-2891		
		1300	154-2878			154-2885	154-2892		
RR5200 L4	RF	210	154-2872	582.8	—	154-2879	154-2886	586.5	—
		290	154-2873			154-2880	154-2887		
		430	154-2874			154-2881	154-2888		
		650	154-2875			154-2882	154-2889		
		850	154-2876			154-2883	154-2890		
		1100	154-2877			154-2884	154-2891		
		1300	154-2878			154-2885	154-2892		

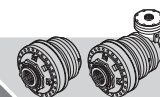

RFF5/..	CFG ①	T <sub>f</sub> [Nm]	CFG ②						
			B			OMTS 12/24 z16	OMVS 10/20 z16		
			code	X3	X4	code	code	X3	X4
RR5200 A3(A)	RF	210	154-2893	—	316.6	154-5338	154-5345	—	320.5
		290	154-2894			154-5339	154-5346		
		430	154-2895			154-5340	154-5347		
		650	154-2896			154-5341	154-5348		
		850	154-2897			154-5342	154-5349		
		1100	154-2898			154-5343	154-5350		
		1300	154-2899			154-5344	154-5351		
RR5200 A4	RF	210	154-2893	—	316.6	154-5338	154-5345	—	320.5
		290	154-2894			154-5339	154-5346		
		430	154-2895			154-5340	154-5347		
		650	154-2896			154-5341	154-5348		
		850	154-2897			154-5342	154-5349		
		1100	154-2898			154-5343	154-5350		
		1300	154-2899			154-5344	154-5351		

CFG	
RF	
B C D	

RF2/..	CFG ①	T <sub>f</sub> [Nm]	CFG ②								
			B			OMP/OMR SAE A 2B Ø 25	OMP/OMR SAE A 2B 1" 6B	OMP/OMR SAE A 4B Ø 25	OMP/OMR SAE A 4B 1" 6B		
			code	X3	X4	code	code	code	code	X3	X4
RR5200 L3	RF	70	154B9195	488.8	—	154B9195M10		154B9195M16	154B9195M17	478.8	—
		140	154B9196			154B9196M10		154B9196M16	154B9196M17		
		210	154B9197			154B9197M10		154B9197M16	154B9197M17		
		320	154B9198			154B9198M10		154B9198M16	154B9198M17		
		430	154B9199			154B9199M10		154B9199M16	154B9199M17		
		600	154B9200			154B9200M10		154B9200M16	154B9200M17		
RR5200 L4	RF	70	154-2345	555.3	—	154-2345M10	154-2345M11	154-2345M16	154-2345M17	545.3	—
		140	154-2346			154-2346M10	154-2346M11	154-2346M16	154-2346M17		
		210	154-2347			154-2347M10	154-2347M11	154-2347M16	154-2347M17		
		320	154-2348			154-2348M10	154-2348M11	154-2348M16	154-2348M17		
		430	154-2349			154-2349M10	154-2349M11	154-2349M16	154-2349M17		
		600	154B9186			154B9186M10	154B9186M11	154B9186M16	154B9186M17		
RR5200 A3(A)	RF	70	154F2991	—	285.3						
		140	154F1890								
		210	154F2961								
		320	154B3591								
		430	154B3592								
		600	154F2992								
RR5200 A4	RF	70	154F2991	—	285.3						
		140	154F1890								
		210	154F2961								
		320	154B3591								
		430	154B3592								
		600	154F2992								

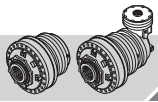

# RR5200

IT EN DE FR ES PT

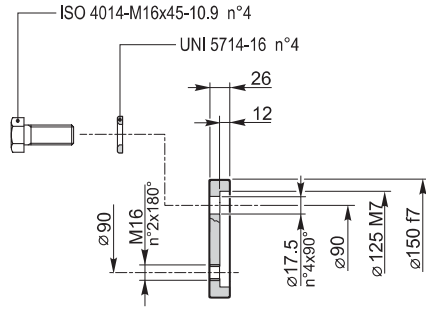
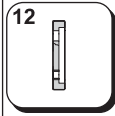

154F6032

Materiale / Material / Material / Matériau / Material / Material:  
 Acciaio / Steel / Stahl / Acier / Acero / Aço  
 EN 10083-1-42CrMo4+QT (1.7225)

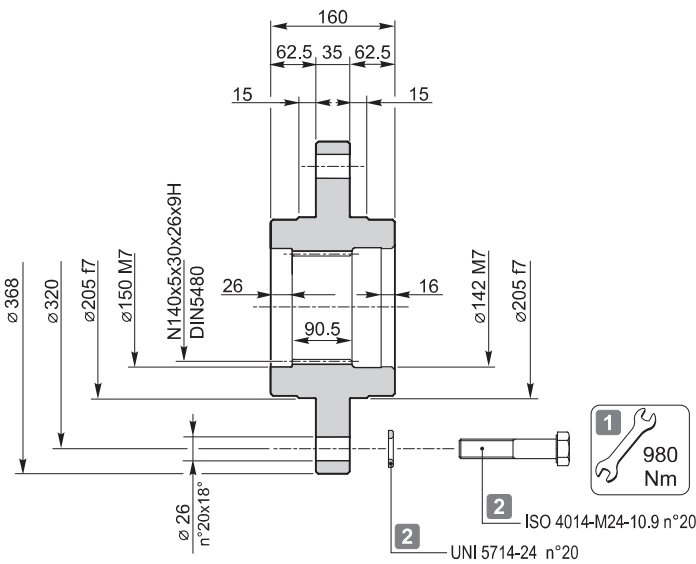
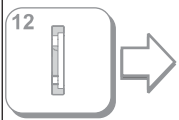
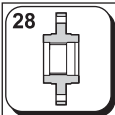

154F6050

Materiale / Material / Material  
 Matériau / Material / Material  
 Acciaio / Steel / Stahl / Acier / Acero / Aço  
 EN 10083-1-C40 (1.1186)

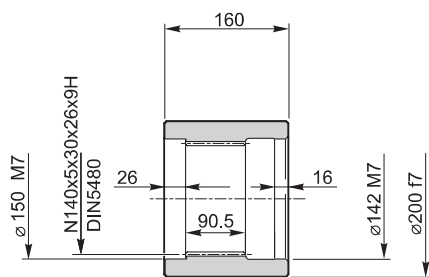
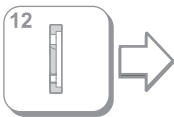

154F6058

Materiale / Materiale / Material / Matériau / Material / Material:  
 Acciaio / Steel / Stahl / Acier / Acero / Aço  
 EN 10083-1-42CrMo4+QT (1.7225)

**1** Coefficiente d'attrito medio considerato: 0.14  
 Average friction coefficient considered: 0.14  
 Durchschnittlicher berücksichtigter Reibungskoeffizient: 0.14  
 Coefficient de frottement moyen considéré: 0.14  
 Coeficiente medio de fricción considerado: 0.14  
 Coeficiente de atrito médio considerado: 0.14

**2** Componenti non forniti da Reggiana Riduttori  
 Components not supplied by Reggiana Riduttori  
 Nicht von Reggiana Riduttori gelieferte Komponenten  
 Parties pas fournies par Reggiana Riduttori  
 Componentes no suministrados por Reggiana Riduttori  
 Componentes não fornecidos por Reggiana Riduttori

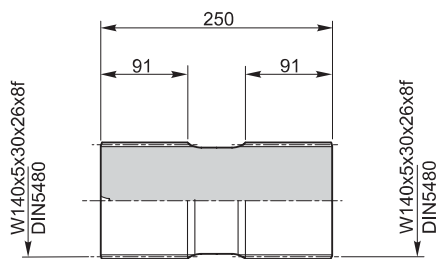
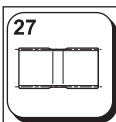
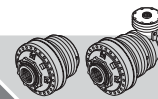

Materiale / Material / Material / Matériau / Material / Material:  
 Acciaio / Steel / Stahl / Acier / Acero / Aço  
 EN 10083-1-42CrMo4+QT (1.7225)

154F6038

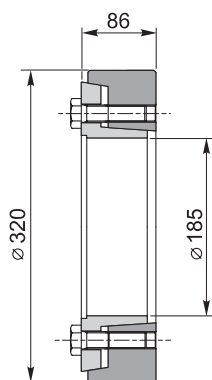
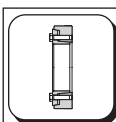

154F6066

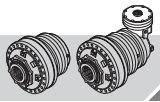

# RR5200

IT EN DE FR ES PT

